

XLF: XL Foundation Screed

- Superior Moisture Protection™
- Available in Copper, Galvanized Steel, Zinc, Stainless Steel or Aluminum

Stucco installation guidelines require stucco to be held up off of hardscape. Provides an extended back leg to protect waterproof membranes. Matching factory miter-cut, solid-soldered inside and outside corners are available, giving you moisture management confidence throughout the entire installation.

Note: Weep holes are available in some configurations. Please call for details.

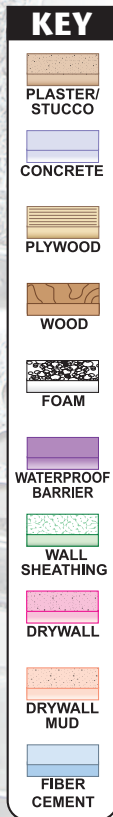
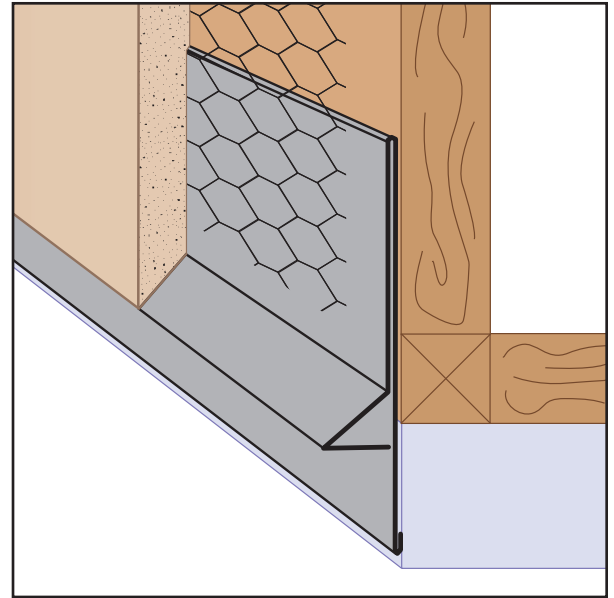

Length	X Size	Y Size	Z Size
10'	1/2"	2 1/2"	2 1/2"
	5/8"	3 1/2"	3"
	3/4"	4"	3 1/2"
	7/8"	4 1/2"	4"
	1"	5"	
	1 3/8"		

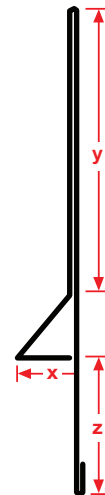
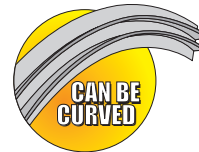

Materials:

- Copper (24ga. - 0.0216" - 16oz)
- Galvanized Steel (26ga. - 0.0217" - G90)
- Zinc (24ga. - 0.0200" - #190)
- Stainless Steel (26ga. - 0.0187" - SAE 304)
 - #2B (Dull Finish)
 - #4 (Brushed Finish)
 - #8 (Mirror Finish)
- Aluminum (22ga. - 0.0253" - 5052 H32)

Note: Standard length is 10 feet. Additional lengths available upon request.

ASTM Codes:

- A580M (Stainless Steel)
- A653/A653M (Galvanized Coating)
- A924 (Galvanized Coating)
- B152/B152M (Copper)
- B209 (Aluminum Sheet)
- B69 (Zinc)
- C1047 (Drywall)
- C1063 (Accessories)
- C841 (Interior Furring and Lathing)

