

SBW: Santa Barbara Weep Screed™

- Available in Copper, Galvanized Steel, Zinc, Stainless Steel or Aluminum
- Available With or Without 1/4" Weep Holes

A unique one piece weep screed design that combines the features of a traditional foundation weep screed while providing an aesthetically pleasing look. The upper leg has a plaster stop with a 1/4" closed hem for safety and weep holes.

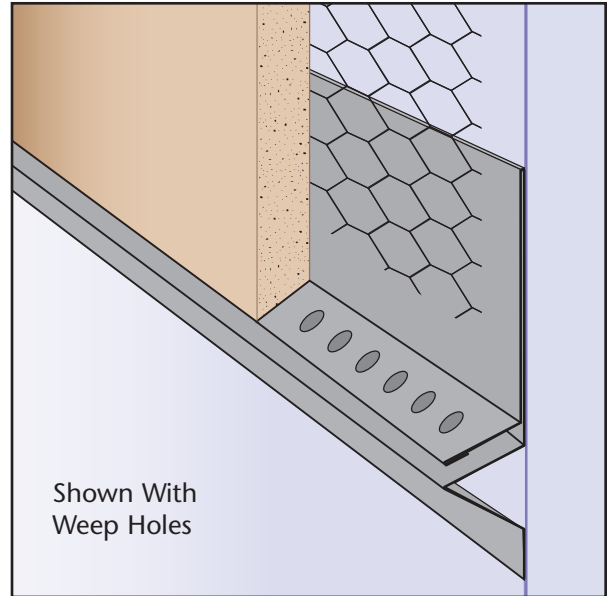

KEY

- PLASTER/STUCCO
- CONCRETE
- PLYWOOD
- WOOD
- FOAM
- WATERPROOF BARRIER
- WALL SHEATHING
- DRYWALL
- DRYWALL MUD
- FIBER CEMENT

Length	X Size	Y Size	Z Size
10'	3/4"	3 1/4"	1/4"
	7/8"		
	1"		
	1 3/8"		

Materials:

- Copper (16oz. (24-266A))
- Galvanized Steel (26-gauge G90)
- Zinc (.020 #190 Pure Zinc Alloy)
- Stainless Steel (304#2 & 304#4)
- Aluminum (5052)

Note: Standard length is 10 feet.
 Available with or without weep holes.

ASTM Codes:

- A580M (Stainless Steel)
- A653/A653M (Galvanized Coating)
- A924 (Galvanized Coating)
- B152/B152M (Copper)
- B209 (Aluminum Sheet)
- B69 (Zinc)
- C1047 (Drywall)
- C1063 (Accessories)
- C841 (Interior Furring and Lathing)

