

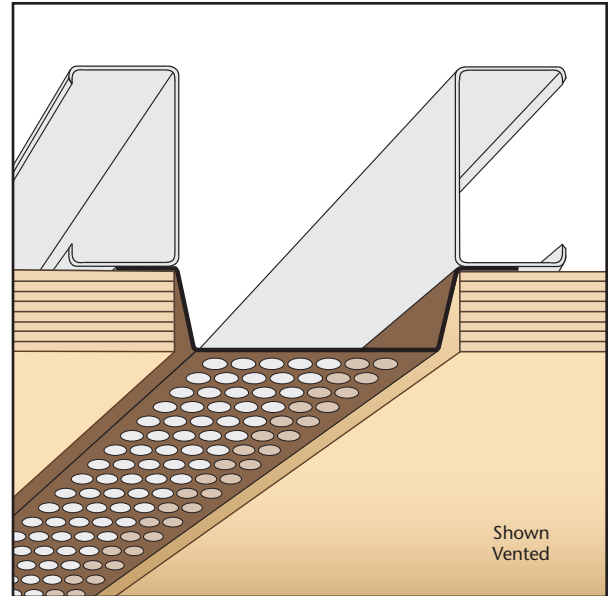

1-87-STOCKTON
 FAX: (702) 651-0948
 office@stocktonproducts.com
 FaceBook.com/stocktonproducts
 www.StocktonProducts.com

PSV: Plywood Style Vent

- Available With 1/8", 1/4" Vent Holes or No Holes
 - Available Pre-Painted Brown or White; or Unpainted
 - Galvanized Steel Only
- Specialty soffit vent for use with plywood soffit conditions.



KEY	
	PLASTER/STUCCO
	CONCRETE
	PLYWOOD
	WOOD
	FOAM
	WATERPROOF BARRIER
	WALL SHEATHING
	DRYWALL
	DRYWALL MUD
	FIBER CEMENT

Length	X Size	Y Size
10'	1/2"	2 1/4"

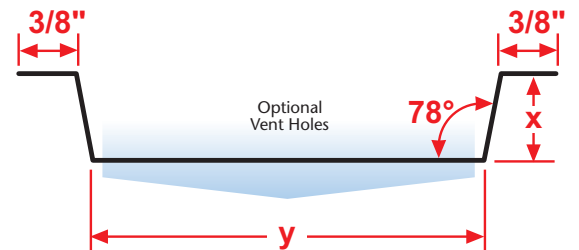

Materials:

- Galvanized Steel (26-gauge G60*)

Note: Standard length is 10 feet.
 Additional lengths available upon request.

Note: *G90 available upon request

ASTM Codes:

- A653/A653M (Galvanized Coating)
- A924 (Galvanized Coating)

