



PRODUCTS™

1-87-STOCKTON

FAX: (702) 651-0948

office@stocktonproducts.com

FaceBook.com/stocktonproducts

www.StocktonProducts.com

# NVS: Narrow V Screed

A narrow control screed that is both decorative and functional. A 1/8" wide expansion screed for conditions that require crack control with a minimal reveal.

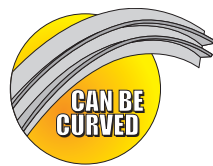
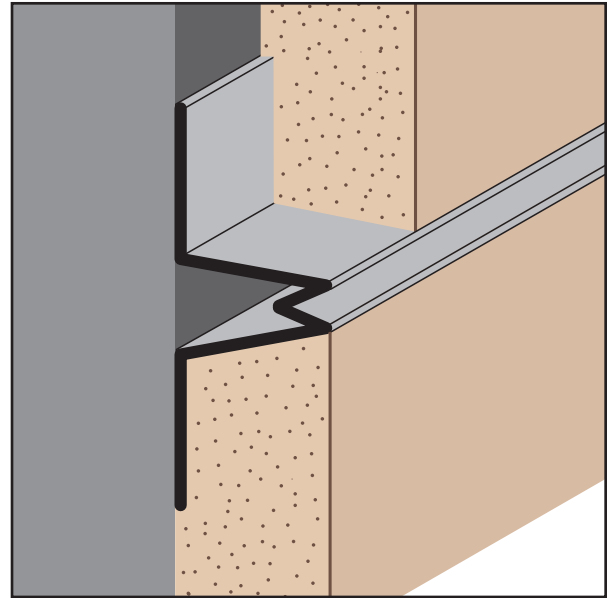

KEY	
	PLASTER/STUCCO
	CONCRETE
	PLYWOOD
	WOOD
	FOAM
	WATERPROOF BARRIER
	WALL SHEATHING
	DRYWALL
	DRYWALL MUD
	FIBER CEMENT

Length	X Size	Y Size
10'	1/2"	1/8"
	3/4"	
	7/8"	

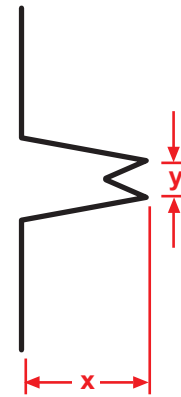

### Materials:

- Aluminum Alloy (6063 T-5)

**Note:** Standard length is 10 feet. Additional lengths available upon request.

### ASTM Codes:

- B136 (Anodize Coating)
- B244 (Anodize Coating)
- C1063 (Accessories)
- D4214 (Paint Films)

