

DRMF: F Wall Reveal

- Available With 1/8" x 1" Vent Slots or No Vents
 - Available Curved Upon Request
 - Available in Aluminum Alloy (6063 T-5)
- F style with a taping flange that creates a reveal and board termination point at tops and bases of walls and at door and window frames. Includes key holes for drywall mud adhesion.

Note: Not all X Sizes (Depth) or Y Sizes (Reveal) combinations are available.

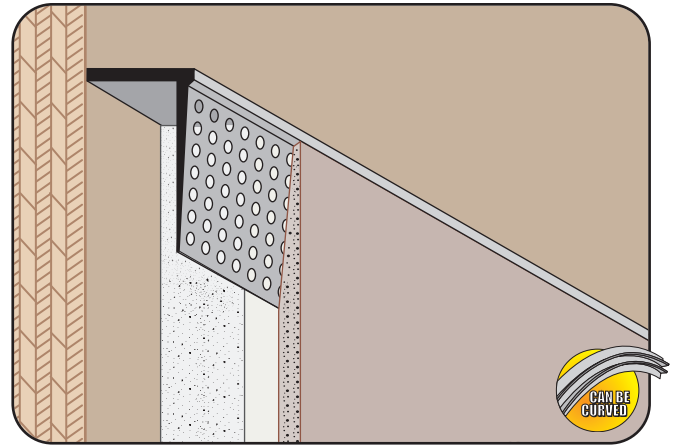

DRML: Edge Trim

- Available Curved Upon Request
 - Available in Aluminum Alloy (6063 T-5)
- L style drywall molding with a taping flange that provides a drywall termination point by capping of the raw edge of the drywall board. Includes key holes for proper plaster adhesion.

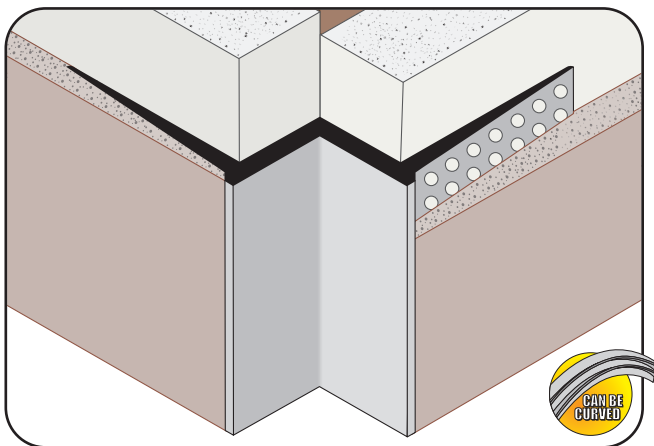

DRMW: W Corner Reveal

- Available Curved Upon Request
 - Available in Aluminum Alloy (6063 T-5)
- W style drywall molding with taping flanges that creates an inverted corner for setbacks, step downs and other special drywall conditions. Includes key holes for proper plaster adhesion.

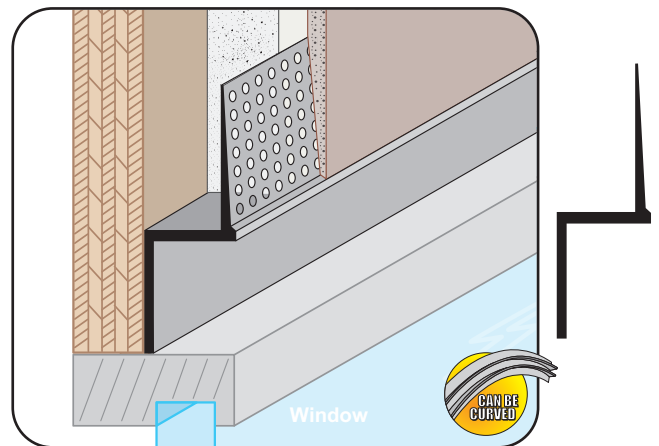

DRMZ: Z Wall Reveal

- Available With 1/8" x 1" Vent Slots or No Vents
 - Available Curved Upon Request
 - Available in Aluminum Alloy (6063 T-5)
- Z style with a taping flange that provides a reveal and a termination point for drywall at door frames, windows and wall bases. Includes key holes for drywall mud adhesion.
- Note:** Not all X, Y and Z combinations are available. Please consult with customer service.