



1-87-STOCKTON
 FAX: (702) 651-0948
 office@stocktonproducts.com
 FaceBook.com/stocktonproducts
 www.StocktonProducts.com

XLF: XL Foundation Screed

- Superior™ Moisture Protection
- Available in Copper, Galvanized Steel, Zinc, Stainless Steel or Aluminum

Stucco installation guidelines require stucco to be held up off of hardscape. Provides an extended back leg to protect waterproof membranes. Matching factory miter-cut, solid-soldered inside and outside corners are available, giving you moisture management confidence throughout the entire installation.

Note: Weep holes are available in some configurations. Please call for details.

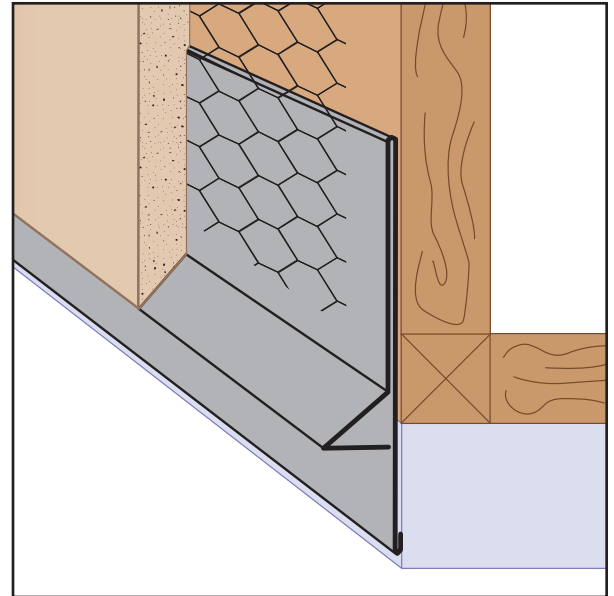

KEY

- PLASTER/STUCCO
- CONCRETE
- PLYWOOD
- WOOD
- FOAM
- WATERPROOF BARRIER
- WALL SHEATHING
- DRYWALL
- DRYWALL MUD
- FIBER CEMENT

Length	X Size	Y Size	Z Size
10'	1/2"	2 1/2"	2 1/2"
	5/8"	3 1/2"	3"
	3/4"	4"	3 1/2"
	7/8"	4 1/2"	4"
	1"	5"	
	1 3/8"		

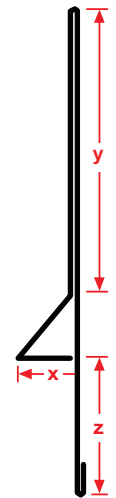
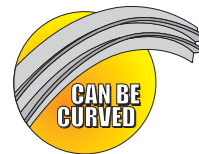

Materials:

- Copper (16oz. (24-266A))
- Galvanized Steel (26-gauge G90)
- Zinc (.020 #190 Pure Zinc Alloy)
- Stainless Steel (304#2 & 304#4)
- Aluminum (5052)

Note: Standard length is 10 feet. Additional lengths available upon request.

ASTM Codes:

- A580M (Stainless Steel)
- A653/A653M (Galvanized Coating)
- A924 (Galvanized Coating)
- B152/B152M (Copper)
- B209 (Aluminum Sheet)
- B221-14 (Aluminum)
- B69 (Zinc)
- C1047 (Drywall)
- C1063 (Accessories)
- C841 (Interior Furring and Lathing)

