

SES: Ember Stop™ Soffit Vent

- **Galvanized Steel Only**
 Allows air in while also designed for protection against ember entry. All the same features and value of our standard SVR screen, but with the addition of a 0.062, 16-16 (1/16") aluminum screen. Includes 1/8" vent holes.

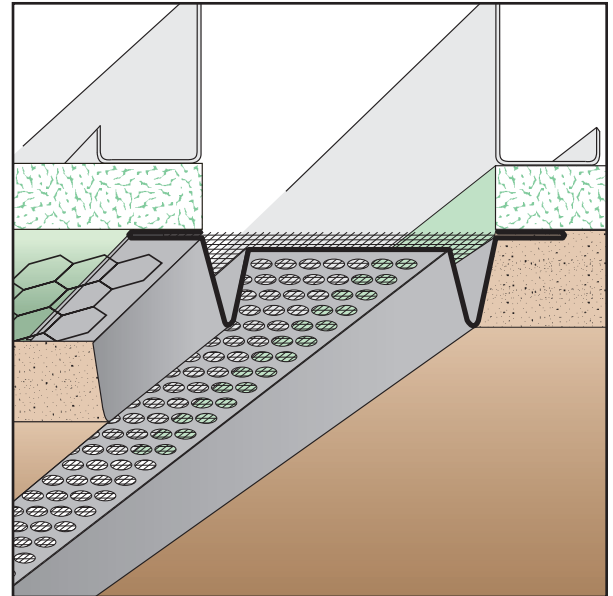

Complies with section 706A, CBSC Wildfire Protection Provisions.

KEY

- PLASTER/STUCCO
- CONCRETE
- PLYWOOD
- WOOD
- FOAM
- WATERPROOF BARRIER
- WALL SHEATHING
- DRYWALL
- DRYWALL MUD
- FIBER CEMENT

Length	X Size	Y Size
10'	1/2"	2"
	3/4"	3"
	7/8"	4"

EXCLUSIVE!

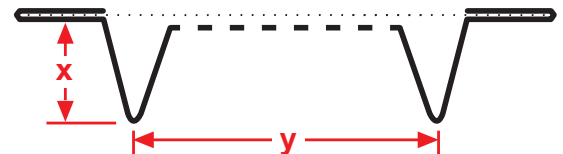

Materials:

- Galvanized Steel (26-gauge G90)

ASTM Codes:

- A653/A653M (Galvanized Coating)
- A924 (Galvanized Coating)

Note: Standard length is 10 feet. Additional lengths available upon request.

