

PWC: Plaster Water-Resistant Channel

- SolidGround® Design For Moisture Protection
- Available With 1/8" Weep Holes or No Holes
- Available in Copper, Galvanized Steel, Zinc, Stainless Steel or Aluminum

One-piece SolidGround® design feature mitigates the concern of moisture penetration in a horizontal condition. Matching factory miter-cut, solid-soldered inside and outside corners are available, giving you moisture management confidence throughout the entire installation.

Note: For Y Sizes over 2", use extruded aluminum or OWC.

Note: Aluminum is not available with 1/8" vent holes.

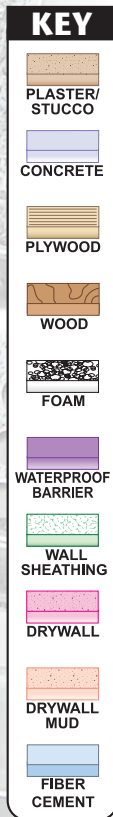
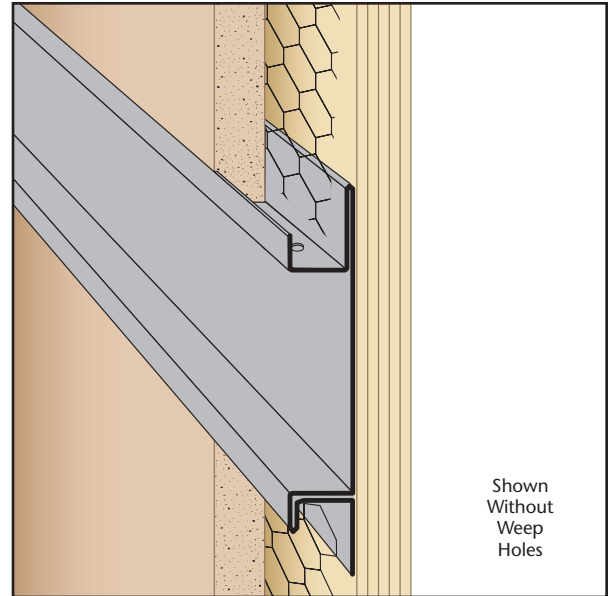

Length	X Size	Y Size
10'	5/8"	1/2"
	3/4"	3/4"
	7/8"	1"
	1"	1 3/8"
	1 3/8"	1 1/2"
		2"

Materials:

- Copper (16oz. (24-266A))
- Galvanized Steel (26-gauge G90)
- Zinc (.020 #190 Pure Zinc Alloy)
- Stainless Steel (304#2 & 304#4)
- Aluminum (5052)

Note: Standard length is 10 feet.
 Additional lengths available upon request.

ASTM Codes:

- A580M (Stainless Steel)
- A653/A653M (Galvanized Coating)
- A924 (Galvanized Coating)
- B152/B152M (Copper)
- B209 (Aluminum Sheet)
- B221-14 (Aluminum)
- B69 (Zinc)
- C1047 (Drywall)
- C1063 (Accessories)
- C841 (Interior Furring and Lathing)

