

OWS: Offset Weep Screed

- Superior™ Moisture Protection
- Available With 1/2" Weep Holes or No Weep Holes
- Available in Copper, Galvanized Steel, Zinc, Stainless Steel or Aluminum

A special weep screed for those conditions where the sheer wall exceeds the foundation in plane. This special design permits the bottom leg of the weep screed to return back to the foundation. When an "Offset" condition exists.

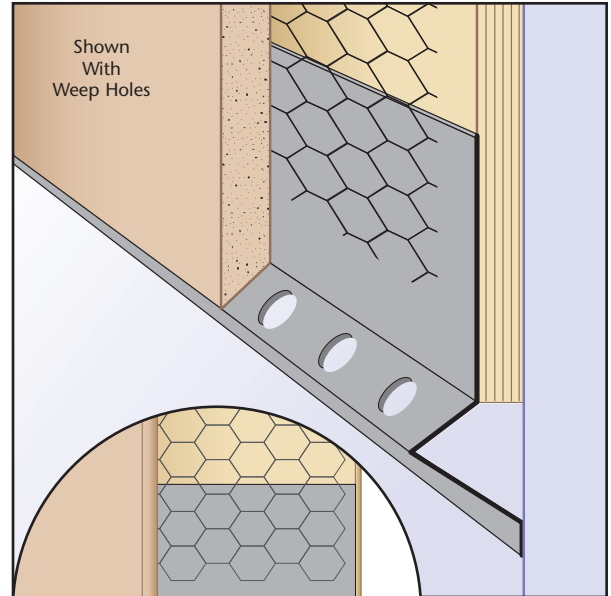

Length	X Size	Y Size	Z Size
10'	1/2"	3 1/2"	3/4"
	3/4"	4"	7/8"
	7/8"	4 1/2"	1"
	1"	5"	1 1/8"
	1 1/2"		1 1/4"
	1 3/8"		1 3/8"
			1 1/2"
			2"

Note: Not all X, Y and Z combinations are available. Please call factory for your specific needs.

Materials:

- Copper (16oz. (24-266A))
- Galvanized Steel (26-gauge G90)
- Zinc (.020 #190 Pure Zinc Alloy)
- Stainless Steel (304#2 & 304#4)
- Aluminum (5052)

Note: Standard length is 10 feet. Additional lengths available upon request.

ASTM Codes:

- A580M (Stainless Steel)
- A653/A653M (Galvanized Coating)
- A924 (Galvanized Coating)
- B152/B152M (Copper)
- B209 (Aluminum Sheet)
- B221-14 (Aluminum)
- B69 (Zinc)
- C1047 (Drywall)
- C1063 (Accessories)
- C841 (Interior Furring and Lathing)

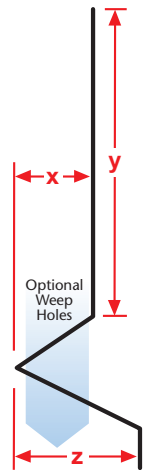

KEY

- PLASTER/STUCCO
- CONCRETE
- PLYWOOD
- WOOD
- FOAM
- WATERPROOF BARRIER
- WALL SHEATHING
- DRYWALL
- DRYWALL MUD
- FIBER CEMENT

