



**SPECIAL SIZES AVAILABLE!**

Contact Stockton  
Custom Fabrication  
at (877) 786-2587

# EXTRUDED

## F MOLD-FCP: F Mold for Fiber Cement Panel

- Available in Aluminum Alloy (6063 T-5)  
Creates a decorative reveal in a wall/soffit transition.

### Most Common Sizes

**X Sizes:** 3/8"

**Y Sizes:** 1/2"

**Length:** 10'

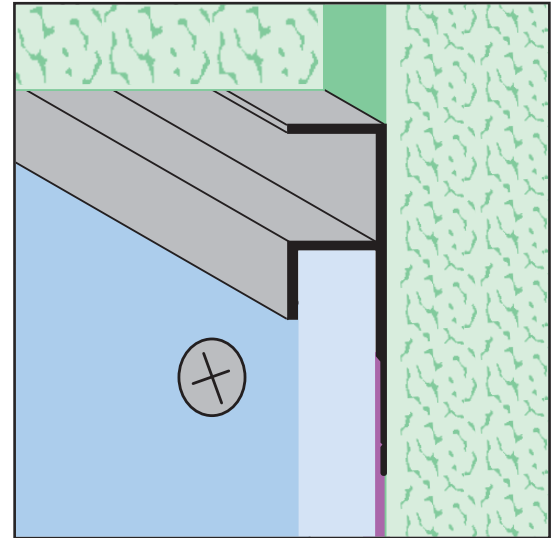
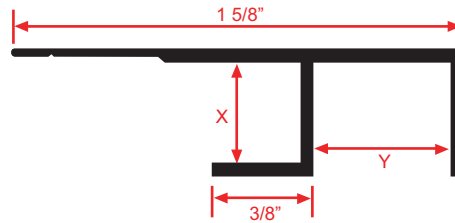

### Most Common Part Numbers:

**F MOLD FCP375 50EC** F Mold-FCP: X=3/8, Y=1/2, Clear Anodize, AL, 10'

**F MOLD FCP375 50EP** F Mold-FCP: X=3/8, Y=1/2, Powder Coated, AL, 10'

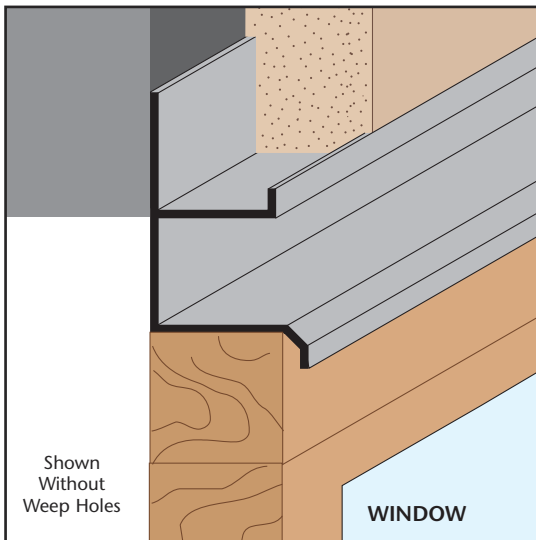

## F-D 75-75: F Drip Molding

- Available With 1/8" Weep Holes or No Vents
- Available Curved Upon Request
- Available in Aluminum Alloy (6063 T-5)

Provides a plaster stop/drip molding with an aesthetic reveal for window heads, tops of door frames and plate conditions where a drip edge is required.

### Most Common Sizes

**X Sizes:** 3/4" or 1 3/8"

**Y Sizes:** 3/4"

**Length:** 10'

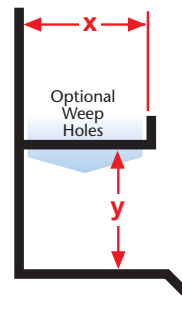

### Most Common Part Numbers:

**F D75 75EC** F-D 75 75: X=3/4, Y=3/4, Clear Anodize, AL, 10'

**F D75 75EDB** F-D 75 75: X=3/4, Y=3/4, Dark Bronze, AL, 10'

**F D75 75ES** F-D 75 75: X=3/4, Y=3/4, Stripped Finish, AL, 10'

**F D75W75ECH** F-D 75 75: X=3/4, Weep, Y=3/4, Chem-Film, AL, 10'