



## SSM: Step Separation Mold

- Special Sizes Available, Contact Customer Service For Details
- Available With 1/8", 1/4" Vent Holes or No Holes
- Available in Aluminum (A), Copper (C), Galvanized Steel (GS), Bonderized (BN), Galvalume® (GVM), Stainless Steel (SS) or Zinc (Z)

(See Our Materials Guide For Details, Page 40)

A versatile molding used primarily to separate either plaster or drywall from other materials.

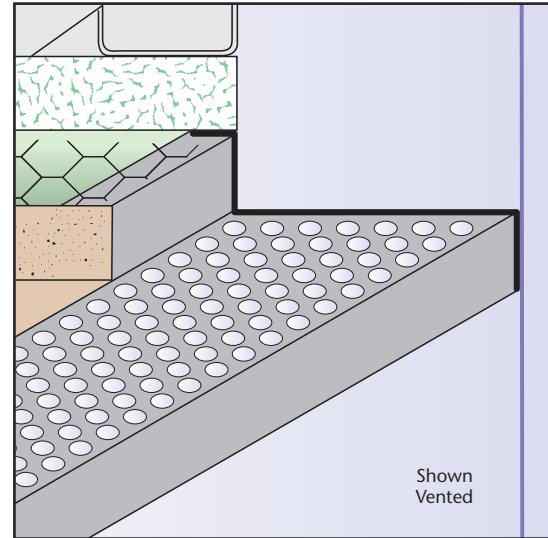

### Most Common Sizes

- X Sizes:** 1/2", 5/8", 3/4", 7/8" or 1"
- Y Sizes:** 3/4", 1", 1 1/2", 2", 3", 3 1/2", 4" or 4 1/2"
- Length:** 120"

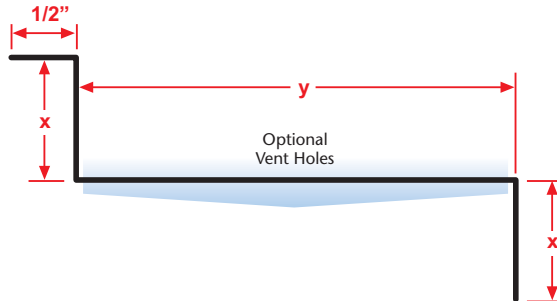

### Most Common Part Numbers:

- SSM034V200** SSM: X=3/4, 1/8 Vent, Y=2, GS, 10'
- SSM058V212J** SSM: X=5/8, 1/4 Vent, Y=2 1/2, GS, 10'

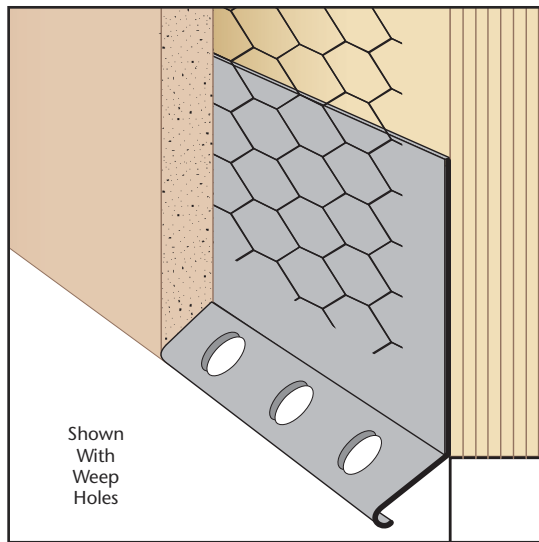

## SST: Stucco Stop (#36)

- Special Sizes Available, Contact Customer Service For Details
  - Superior™ Moisture Protection
  - Available With 1/2" Weep Holes or No Weep Holes
  - Available Curved Upon Request
  - Available in Aluminum (A), Copper (C), Galvanized Steel (GS), Bonderized (BN), Galvalume® (GVM), Stainless Steel (SS) or Zinc (Z)
- (See Our Materials Guide For Details, Page 40)

A variation of the traditional weep screed that provides a plaster stop and weep function at the foundation line.

### Most Common Sizes

- X Sizes:** 1/2", 3/4", 7/8", 1" or 1 3/8"
- Y Sizes:** 3 1/2", 4 1/2" or 5"
- Length:** 120"

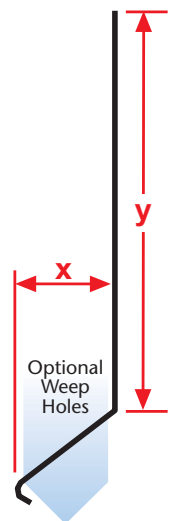

### Most Common Part Numbers:

- SST012W500J** SST: X=1/2, 1/4 Weep Hole, Y=5, GS, 10'
- SST034 312** SST: X=3/4, Y=3 1/2, GS, 10'
- SST034W312L** SST: X=3/4, 1/2 Weep Hole, Y=3 1/2, GS, 10'
- SST058W312J** SST: X=5/8, 1/4 Weep Hole, Y=3 1/2, GS, 10'
- SST078 312** SST: X=7/8, Y=3 1/2, GS, 10'
- SST078W312L** SST: X=7/8, 1/2 Weep Hole, Y=3 1/2, GS, 10'
- SST078W312LC** SST: X=7/8, 1/2 Weep Hole, Y=3 1/2, C, 10'
- SST100W312L** SST: X=1, 1/2 Weep Hole, Y=3 1/2, GS, 10'