

SFS: Single Flange Screed

- Special Sizes Available, Contact Customer Service For Details
 - Available With 1/8", 1/4" Vent Holes or No Vent
 - Available Curved Upon Request
 - Available in Aluminum (A), Copper (C), Galvanized Steel (GS), Bonderized (BN), Galvalume® (GVM), Stainless Steel (SS) or Zinc (Z)
- (See Our Materials Guide For Details, Page 40)

Same as our standard vent, less one flange, designed to butt against walls on one side while providing a plaster stop on the other. Can be used in ceiling/wall or base conditions providing perimeter airflow. Available non-vented for use as a decorative reveal upon request.

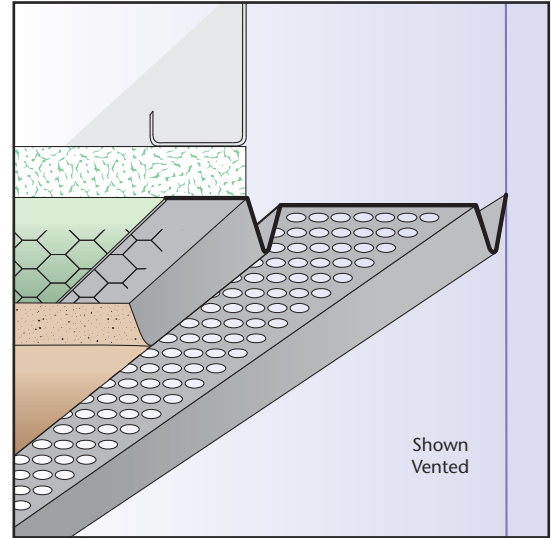

Most Common Sizes

X Sizes: 3/8", 1/2", 5/8", 3/4", 7/8", 1" or 1 3/8"

Y Sizes: 3/4", 1", 1 1/2", 2", 2 1/2", 3", 3 1/2", 4", 4 1/2", 5", 5 1/2" or 6"

Length: 120"

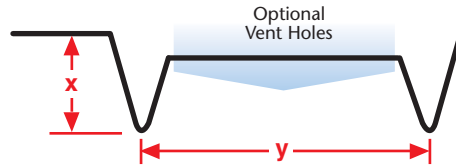

Most Common Part Numbers:

SFS012V200 SFS: X=1/2, 1/8 Vent, Y=2, GS, 10'

SFS012V200J SFS: X=1/2, 1/4 Vent, Y=2, GS, 10'

SFS012V300 SFS: X=1/2, 1/8 Vent, Y=3, GS, 10'

SFS034V200 SFS: X=3/4, 1/8 Vent, Y=2, GS, 10'

SFS034V200J SFS: X=3/4, 1/4 Vent, Y=2, GS, 10'

SFS034V300 SFS: X=3/4, 1/8 Vent, Y=3, GS, 10'

SFS034V300J SFS: X=3/4, 1/4 Vent, Y=3, GS, 10'

SFS078V200 SFS: X=7/8, 1/8 Vent, Y=2, GS, 10'

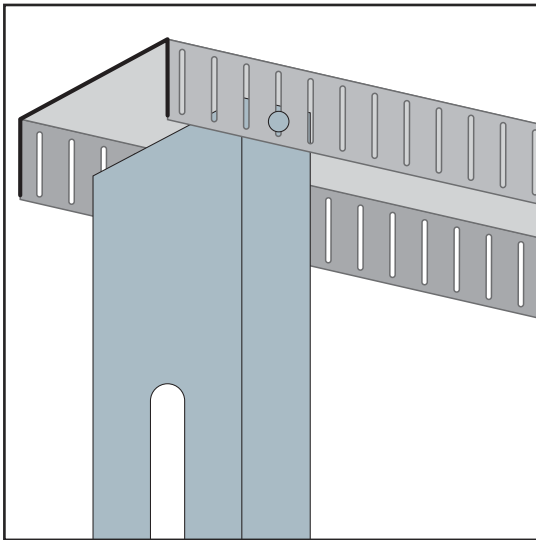

SLT: Slotted Slip Track

- Special Sizes Available, Contact Customer Service For Details
 - Available in Galvanized Steel (GS)
- (See Our Materials Guide For Details, Page 40)

Our Slip Slotted Track is a deflection track with slots in the legs to allow for vertical deflection. Giving you head of wall vertical deflection and the added horizontal drift movement. The top of the stud floats within the track legs. This connection allows for vertical movement without transferring the loads to the wall studs themselves.

Most Common Sizes

X Sizes: User Defined

Y Sizes: User Defined

Length: 120" or 144"

1/4" x 1 1/2" Slots on a 2 1/2" Standard Flange

