



CTM: Corner Transition Mold

- Special Sizes Available, Contact Customer Service For Details
- Available With 1/8", 1/2" Weep Holes or No Holes
- Available in Aluminum (A), Copper (C), Galvanized Steel (GS), Bonderized (BN), Galvalume® (GVM), Stainless Steel (SS) or Zinc (Z)

(See Our Materials Guide For Details, Page 40)

A plaster stop used in various applications to finish an edge or bridge when using dissimilar materials. Can be used to support acoustical tile or to case off windows.

Most Common Sizes

X Sizes: 1/2", 5/8", 3/4", 7/8" or 1"

Y Sizes: 1", 2" or 3"

Length: 120"

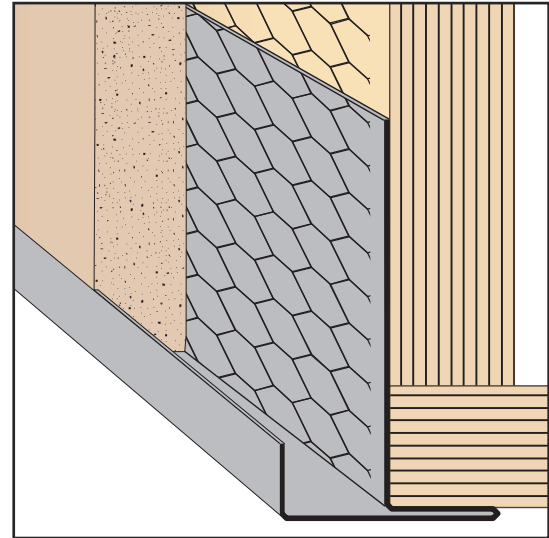
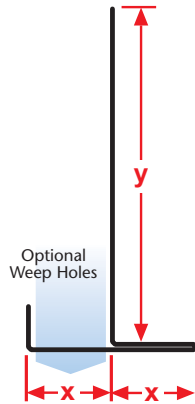

Most Common Part Numbers:

CTM034 200 CTM: X=3/4, Y=2, GS, 10'

CTM078 200 CTM: X=7/8, Y=2, GS, 10'

CTM078 200 138 CTM: X=7/8, Y=2, GS, 10', 1 3/8 Return

CTM078 212A CTM: X=7/8, Y=2 1/2, AL, 10'

CTM078 212A CTM: X=7/8, Y=2 1/2, AL, 10'

CTM078 300 CTM: X=7/8, Y=2, GS, 10'

CTM078 412A CTM: X=7/8, Y=4 1/2, A, 10'

CTM78W312L CTM: X=7/8, 1/2 Weep Hole, Y=2, GS, 10'

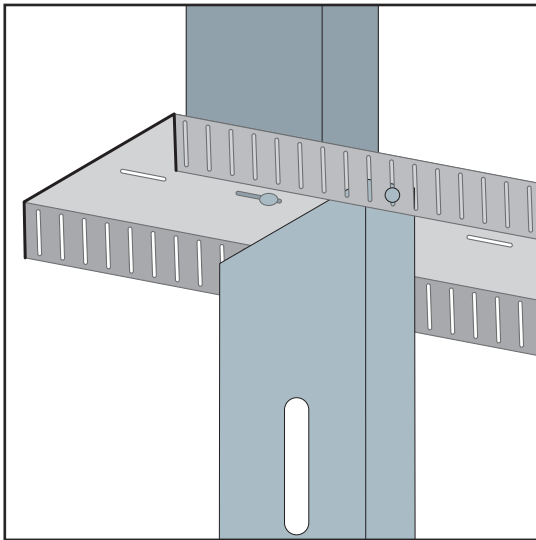

D-T: Drift Track

- Special Sizes Available, Contact Customer Service For Details
 - Available in Galvanized Steel (GS)
- (See Our Materials Guide For Details, Page 40)

Our Drift Track is a deflection track with slots in the legs to allow for vertical deflection, and slots in the web to allow for horizontal drift when required by seismic designs. Giving you head of wall vertical deflection and the added horizontal drift movement. The top of the stud floats within the track legs. This connection allows for vertical movement without transferring the loads to the wall studs themselves.

Most Common Sizes

X Sizes: User Defined

Y Sizes: User Defined

Length: 120" or 144"

1/4" x 1 1/2" Slots on a 2 1/2" Standard Flange

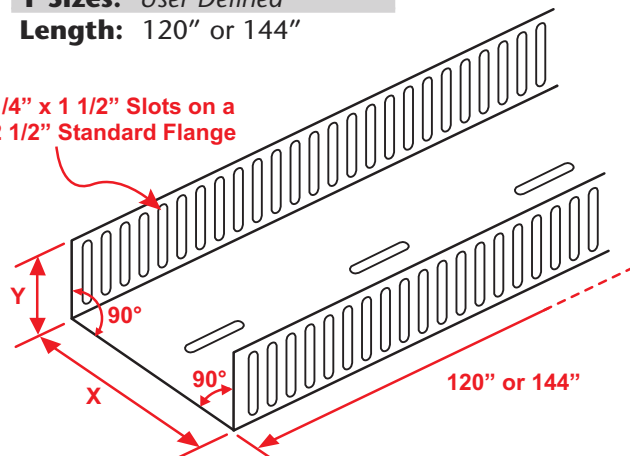

NEW