

### CR-FCP: Channel Reveal for FCP

- Not Available Vented
  - Available in Aluminum Alloy (6063 T-5)
- A decorative reveal used to create an aesthetically pleasing vertical accent between panels.
- Note:** Do not use in a horizontal condition. Attach panel per manufacturer's recommended installation instructions.

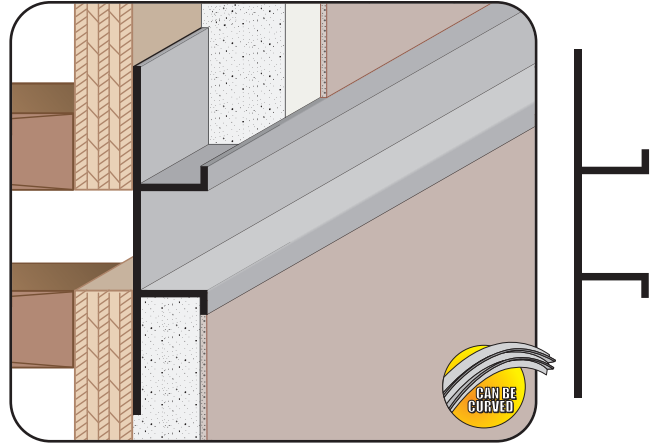

### DCS: Drywall Channel Screed

- Available With 1/8" x 1" Vent Slots or No Vents
  - Available Curved Upon Request
  - Available in Aluminum Alloy (6063 T-5)
- Drywall version of the plaster channel screed used to create a decorative reveal and to separate dissimilar materials. Used with one-coat stucco and direct applied systems. Available with 1/8" weep holes.
- Note:** Not available with a 1 1/2" Y Size.

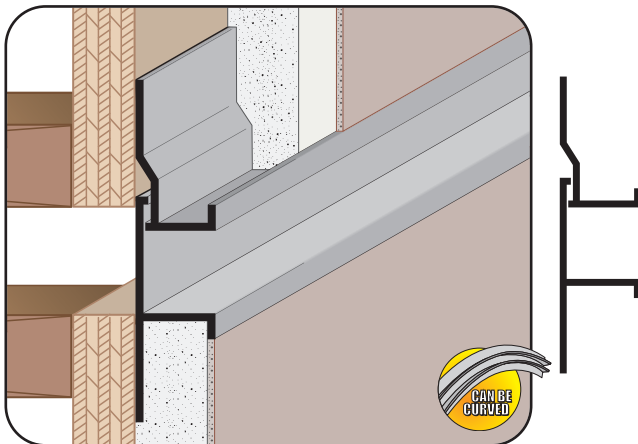

### DCS 50-2: Drywall Channel Screed 50 - 2 Piece

- Available With 1/8" x 1" Vent Slots or No Vents
  - Available Curved Upon Request
  - Available in Aluminum Alloy (6063 T-5)
- A two-piece version of the DCS series molding that provides 1/4" +/- movement where a "true" expansion joint is required. Used for stucco over block or when only a 1/2" depth is required.

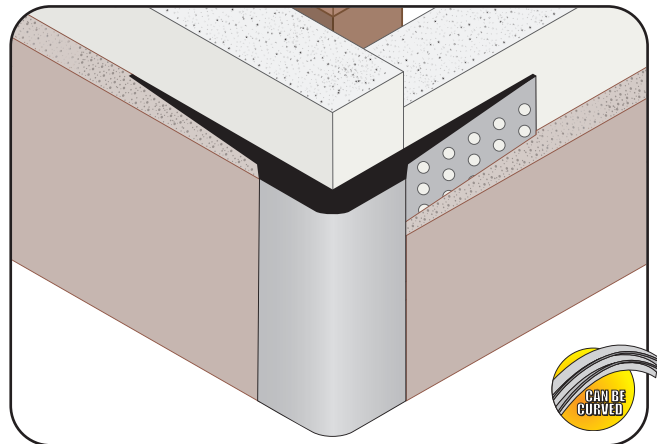

### DMCT: High Strength Corner Trim

- Available Curved Upon Request
  - Available in Aluminum Alloy (6063 T-5)
- A 90° outside corner with tapping flanges for drywall. Provides a high strength corner for high impact areas. Includes key holes for proper plaster adhesion.