

SB-FCP: Starter Base for FCP

- Available in Aluminum Alloy (6063 T-5)
- A functional starter trim piece for the fiber cement panel (also known as hardie board) that also provides a weep point for moisture.
- Note:** Attach panel per manufacturer's recommended installation instructions.

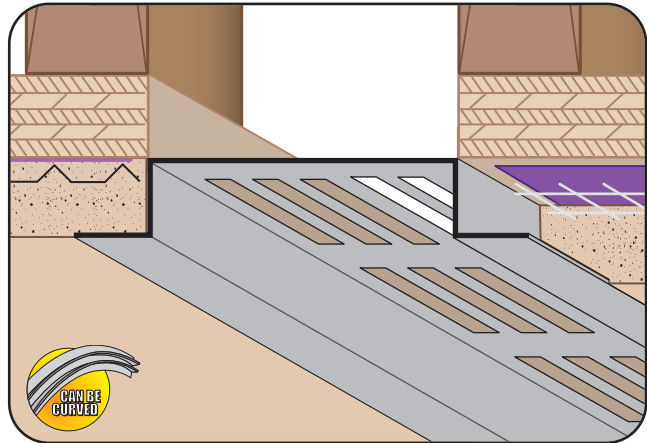

SV: Soffit Vent

- Available With 1/8" x 1" Vent Slots or No Vents
 - Available Curved Upon Request
 - Available in Aluminum Alloy (6063 T-5)
- For use with E.I.F.S. as a soffit vent.
- Note:** 1/2" X Size available in 2" Y Size only. Not all X Sizes (Depth) or Y Sizes (Reveal) combinations are available. Please consult with customer service.

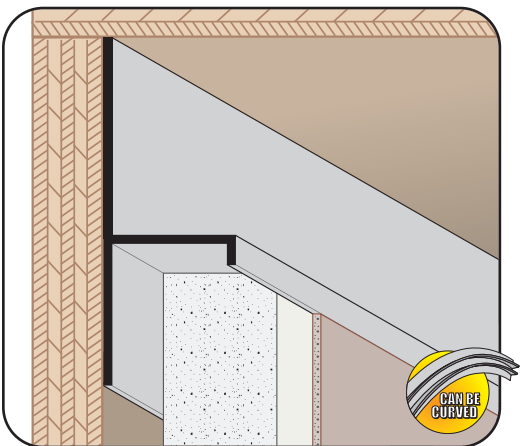

TDM: T Drywall Molding

- Available With 1/8" x 1" Vent Slots or No Vents
 - Available Curved Upon Request
 - Available in Aluminum Alloy (6063 T-5)
- Provides a reveal and acts as a drywall stop/control screed for drywall at wall base and column base conditions where a reveal and stop are required. Can be used to create a reveal at ceiling/wall conditions.

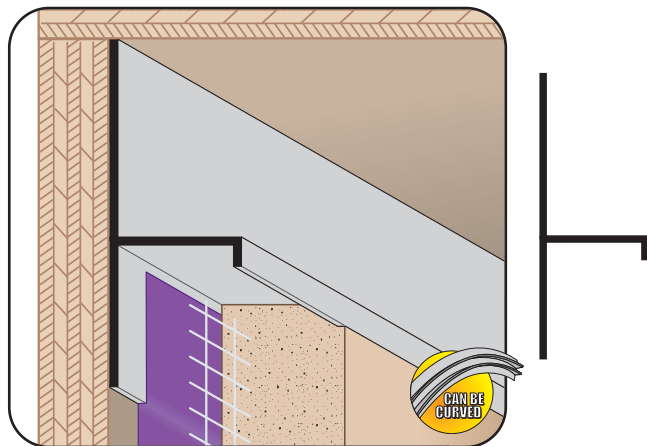

TRM: T Reveal Molding

- Available With 1/8" x 1" Vent Slots or No Vents
 - Available Curved Upon Request
 - Available in Aluminum Alloy (6063 T-5)
- Provides a reveal and acts as a plaster stop/control screed for conventional 3-coat stucco at wall base and column base conditions where a reveal and plaster stop are required. Can be used to create a reveal at ceiling/wall conditions.

