



CUSTOM SIZES AVAILABLE!

Stockton Custom Fabrication

877-786-2587

custom@StocktonProducts.com



PRODUCTS™

WVS: Wide V Screed

- Custom Sizes Available, Contact Customer Service For Details
- Available Curved Upon Request
- Available in Aluminum (A), Copper (C), Galvanized Steel (GS), Bonderized (BN), Galvalume® (GVM), Stainless Steel (SS) or Zinc (Z)

A decorative plaster control joint for conditions that require a small or minimal reveal.

Most Common Sizes

X Sizes: 1/2", 3/4", 7/8", 1" or 1 1/4"

Y Sizes: 1/2", 5/8" or 3/4"

Length: 120"

Materials And Finishes:

Details: stpro.us/MET

Aluminum (A), Copper (C), Galvanized Steel (GS), Bonderized (BN), Galvalume® (GVM), Stainless Steel (SS) or Zinc (Z)

ASTM Codes:

Details: stpro.us/ASTM

All Accessories are fabricated from prime galvanized steel G90 zinc coating by the hot dipped method, conforming to steel and coating specification ASTM A-653/A-653M or zinc alloy meeting ASTM B-69. Stainless Steel A480/A480M A580M (Stainless Steel) For installation and placement instructions refer to ASTM C1063, C841 and C926.

Most Common Part Numbers:

WVS034 012 WVS: X=3/4, Y=1/2, GS, 10'

WVS034 058 WVS: X=3/4, Y=5/8, GS, 10'

WVS034 058 WVS: X=3/4, Y=5/8, GS, 10'

WVS078 012SS WVS: X=7/8, Y=1/2, SS, 10'

WVS078 012 WVS: X=7/8, Y=1/2, GS, 10'

WVS078 012Z WVS: X=7/8, Y=1/2, Z, 10'

WVS078 058 WVS: X=7/8, Y=5/8, GS, 10'

WVS100 034SS4 WVS: X=1, Y=3/4, SS, 4'

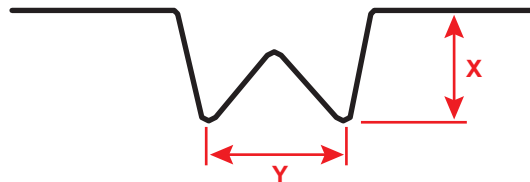
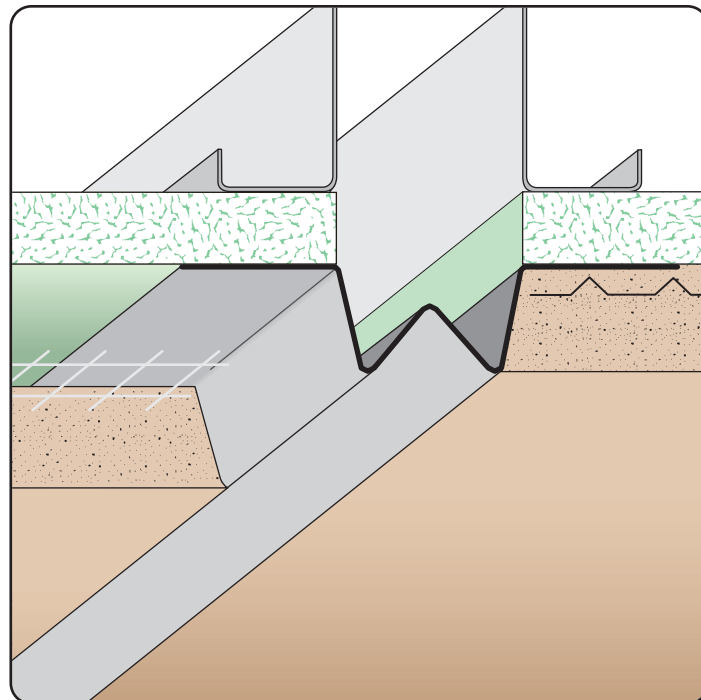

QUOTE

Company: _____
 Name: _____
 Address: _____
 City: _____
 State/ZIP: _____
 Phone: _____
 eMail: _____

QTY: _____
 Material/Gauge: _____
 X Size: _____
 Y Size: _____
 Length: _____

PO Number: _____
 Job/Project: _____
 Notes: _____

877-786-2587 • StocktonProducts.com

