

PCM: Plaster Corner Molding

- Available Curved Upon Request
 - Available in Aluminum Alloy (6063 T-5)
- Creates a plaster stop and high strength corner for conventional 3-coat stucco with an aesthetically pleasing exposed edge at all outside corner conditions.

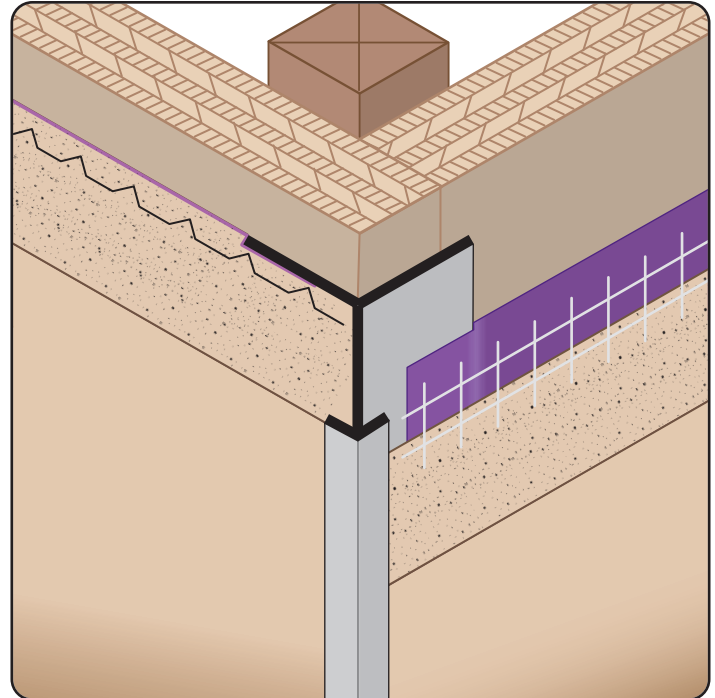

Most Common Sizes
Y Sizes: 3/4", 7/8" or 1 5/8"
Length: 10'

Materials And Finishes:

Details: stpro.us/EXT
 Aluminum Alloy (6063 T-5)

ASTM Codes:

Details: stpro.us/ASTM
 AA-M32-C10A21, AAMA 605.2, C841, C1047, C1063,
 B136-84, B244-97, D4214-98, ND1730-67-TYPE B

Most Common Part Numbers:

- PCM1625EC** PCM: X=3/4, Y=1 5/8, Powder Coated, A, 10'
- PCM75EB** PCM: X=3/4, Y=3/4, Black Anodize, A, 10'
- PCM75EC** PCM: X=3/4, Y=3/4, Clear Anodize, A, 10'
- PCM75EK** PCM: X=3/4, Y=3/4, Fluorophore Paint, A, 10'

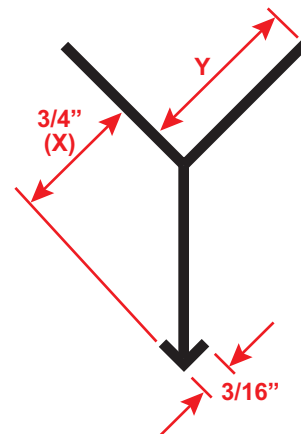

QUOTE	Company: _____	QTY: _____	PO Number: _____
	Name: _____	Material: Aluminum Alloy (6063 T-5)	Job/Project: _____
	Address: _____	Y Size: _____	Notes: _____
	City: _____	Length: _____	_____
	State/ZIP: _____		_____
	Phone: _____		_____
	eMail: _____		_____

877-786-2587 • StocktonProducts.com

