



CUSTOM SIZES AVAILABLE!

Stockton Custom Fabrication

877-786-2587

custom@StocktonProducts.com



PRODUCTS™

PBS: Pointed Base Screed

- Custom Sizes Available, Contact Customer Service For Details
- Available With 1/2" Key Holes or No Holes
- Available in Aluminum (A), Copper (C), Galvanized Steel (GS), Bonderized (BN), Galvalume® (GVM), Stainless Steel (SS) or Zinc (Z)

Pointed base screed functions as a control joint and depth screed in the plaster. The base screed comes with or without 1/2" key holes in the flange for a mechanical key.

Most Common Sizes

X Sizes: 1/2", 3/4", 7/8" or 1 1/4"

Length: 120"

Materials And Finishes:

Details: stpro.us/MET

Aluminum (A), Copper (C), Galvanized Steel (GS), Bonderized (BN), Galvalume® (GVM), Stainless Steel (SS) or Zinc (Z)

ASTM Codes:

Details: stpro.us/ASTM

All Accessories are fabricated from prime galvanized steel G90 zinc coating by the hot dipped method, conforming to steel and coating specification ASTM A-653/A-653M or zinc alloy meeting ASTM B-69. Stainless Steel A480/A480M A580M (Stainless Steel) For installation and placement instructions refer to ASTM C1063, C841 and C926.

Most Common Part Numbers:

PBS012 000 PBS: X=1/2, GS, 10'

PBS012W000 PBS: X=1/2, 1/8 Weep Hole, GS, 10'

PBS034 000SS PBS: X=3/4, SS, 10'

PBS034W000 PBS: X=3/4, 1/8 Weep Hole, GS, 10'

PBS078 000 PBS: X=7/8, GS, 10'

PBS078 000SS PBS: X=7/8, SS, 10'

PBS078W000 PBS: X=7/8, 1/8 Weep Hole, GS, 10'

PBS114 000 PBS: X=1 1/4, GS, 10'

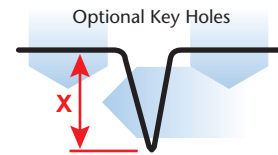
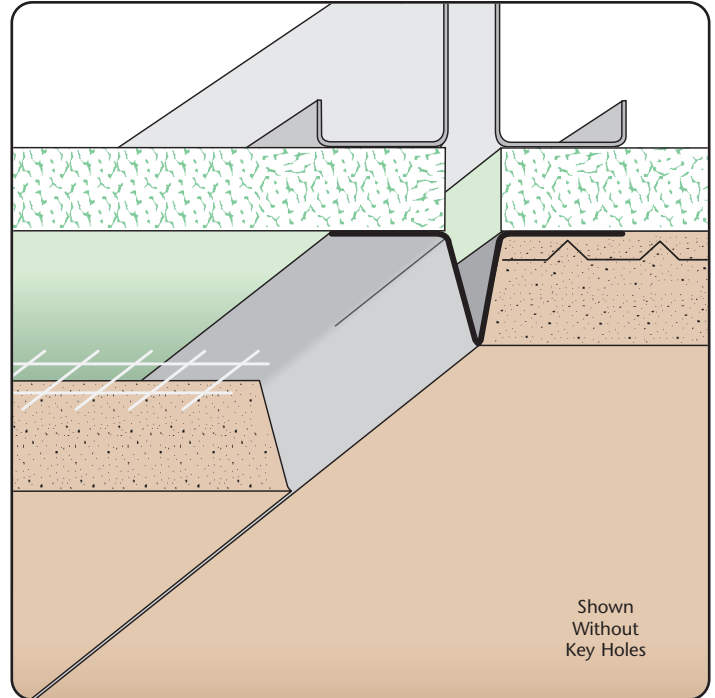

QUOTE	Company: _____	QTY: _____	PO Number: _____
	Name: _____	Material/Gauge: _____	Job/Project: _____
	Address: _____	X Size: _____	Notes: _____
	City: _____	Length: _____	_____
	State/ZIP: _____	Key Holes: <input type="checkbox"/> None <input type="checkbox"/> 1/2"	_____
	Phone: _____		_____
	eMail: _____		_____

877-786-2587 • StocktonProducts.com

