

# OC-FCP: Outside Corner for Fiber Cement Panel

- Available in Aluminum Alloy (6063 T-5)  
Creates a decorative reveal and a high strength protective corner at an outside corner condition.
- Note:** Attach panel per manufacturer's recommended installation instructions.

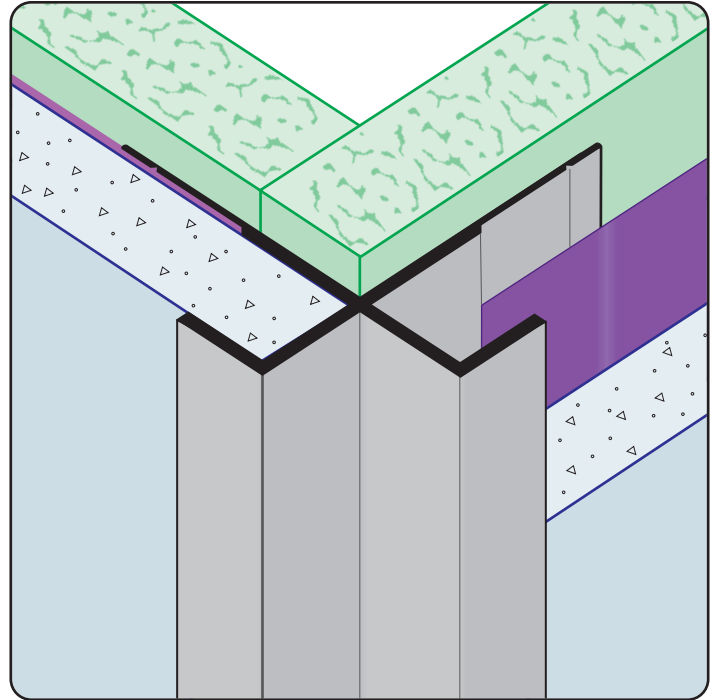

### Most Common Sizes

**Length:** 10'

### Materials And Finishes:

**Details:** [stpro.us/EXT](http://stpro.us/EXT)

Aluminum Alloy (6063 T-5)

### ASTM Codes:

**Details:** [stpro.us/ASTM](http://stpro.us/ASTM)

AA-M32-C10A21, AAMA 605.2, C841, C1047, C1063, B136-84, B244-97, D4214-98, ND1730-67-TYPE B

### Most Common Part Numbers:

- OC FCP375 375EC** OC-FCP: X=3/8, Y=3/8, Clear Anod, A, 10'
- OC FCP375 375EC** OC-FCP: X=3/8, Y=3/8, Clear Anod, A, 10'
- OC FCP375 375EK** OC-FCP: X=3/8, Y=3/8, Fluorophore Paint,AL, 10'
- OC FCP375 375EP** OC-FCP: X=3/8, Y=3/8, Powder Coated, AL, 10'
- OC FCP375 375ES** OC-FCP: X=3/8, Y=3/8, Powder Coated, AL, 10'

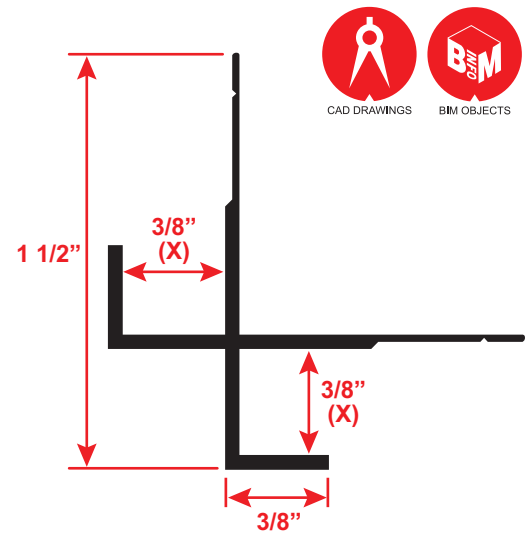

<b>QUOTE</b>	Company: _____	QTY: _____	PO Number: _____
	Name: _____	Material: Aluminum Alloy (6063 T-5)	Job/Project: _____
	Address: _____	Length: _____	Notes: _____
	City: _____		_____
	State/ZIP: _____		_____
	Phone: _____		_____
	eMail: _____		_____

**877-786-2587 • StocktonProducts.com**

