

JPM: J Plaster Molding

- Available Curved Upon Request
 - Available in Aluminum Alloy (6063 T-5)
- A plaster stop/casing bead for conventional 3-coat stucco used in a variety of conditions that gives a nice finished look at all plaster terminations.

Note: *2" Y Size available on 1 1/2" and 1 3/8" X Size only.

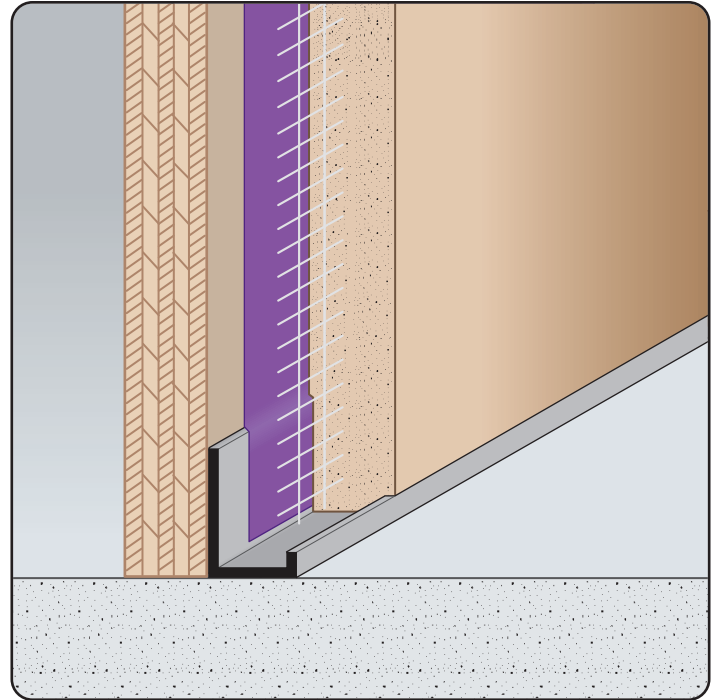

Most Common Sizes

X Sizes: 3/4", 1", 1 1/2" or 1 3/8"

Y Sizes: 1 1/8" or *2"

Length: 10'

Materials And Finishes:

Details: stpro.us/EXT

Aluminum Alloy (6063 T-5)



ASTM Codes:

Details: stpro.us/ASTM

AA-M32-C10A21, AAMA 605.2, C841, C1047, C1063, B136-84, B244-97, D4214-98, ND1730-67-TYPE B

Most Common Part Numbers:

JPM100EC JPM: X=1, Y=1 1/8, Clear Anodize, A, 10'

JPM138EC JPM: X=1 3/8, Y=1 1/8, Clear Anodize, A, 10'

JPM150EC JPM: X=1 1/2, Y=1 1/8, Clear Anodize, A, 10'

JPM75EC JPM: X=3/4, Y=1 1/8, Clear Anodize, A, 10'

JPM75EC JPM: X=3/4, Y=1 1/8, Clear Anodize, A, 10'

JPM75EK JPM: X=3/4, Y=1 1/8, Fluorophore Paint, A, 10'

JPM75EK JPM: X=3/4, Y=1 1/8, Fluorophore Paint, A, 10'

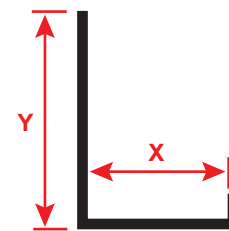

QUOTE	Company: _____	QTY: _____	PO Number: _____
	Name: _____	Material: Aluminum Alloy (6063 T-5)	Job/Project: _____
	Address: _____	X Size: _____	Notes: _____
	City: _____	Y Size: _____	_____
	State/ZIP: _____	Length: _____	_____
	Phone: _____		_____
	eMail: _____		_____

877-786-2587 • StocktonProducts.com

