



**CUSTOM SIZES AVAILABLE!**

Stockton Custom Fabrication

877-786-2587

custom@StocktonProducts.com



**PRODUCTS™**

# FTM: Fascia Transition Mold

- Custom Sizes Available, Contact Customer Service For Details
- Available With 1/8", 1/4" Vent Holes or No Vent
- Available With 1/8" Weep Holes or No Weep Holes
- Available in Aluminum (A), Copper (C), Galvanized Steel (GS), Bonderized (BN), Galvalume® (GVM), Stainless Steel (SS) or Zinc (Z)

Creates a fascia/soffit transition providing a small overhang to prevent moisture from migrating back to the soffit surface. Prevents water staining on plaster by creating a drip edge. Can be vented for perimeter airflow into space above the soffit.

### Most Common Sizes

**X Sizes:** 1/2", 5/8", 3/4", 7/8", 1" or 1 3/8"

**Y Sizes:** 3/4", 1", 1 1/2", 2", 2 1/2", 3", 3 1/2", 4" or 4 1/2"

**Length:** 120"

### Materials And Finishes:

Details: [stpro.us/MET](http://stpro.us/MET)

Aluminum (A), Copper (C), Galvanized Steel (GS), Bonderized (BN), Galvalume® (GVM), Stainless Steel (SS) or Zinc (Z)

### ASTM Codes:

Details: [stpro.us/ASTM](http://stpro.us/ASTM)

653-CS, A1018, A262, A36, A513, A653, A792, A924, B 370-12, B-209, B-209, B6/B69, C1047, C1063, C841, ML/SFA 920

### Most Common Part Numbers:

|                     |  |
|---------------------|--|
| <b>FTM034 138</b>   | FTM: X=3/4, Y=1 3/8, GS, 10'               |
| <b>FTM034V138</b>   | FTM: X=3/4, 1/8 Vent, Y=1 3/8, GS, 10'     |
| <b>FTM034V212</b>   | FTM: X=3/4, 1/8 Vent, Y=2 1/2 GS, 10'      |
| <b>FTM078V200</b>   | FTM: X=7/8, 1/8 Vent, Y=2, GS, 10'         |
| <b>FTM078V312</b>   | FTM: X=7/8, 1/8 Vent, Y=3 1/2, GS, 10'     |
| <b>FTM078V412</b>   | FTM: X=7/8, 1/8 Vent, Y=4 1/2, GS, 10'     |
| <b>FTM078W312LZ</b> | FTM: X=7/8, 1/2 Weep Hole, Y=3 1/2, Z, 10' |

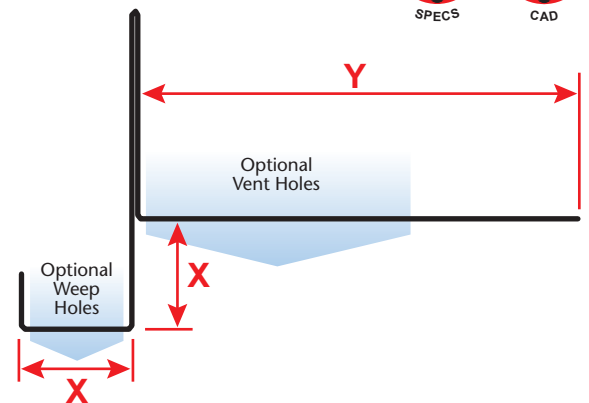
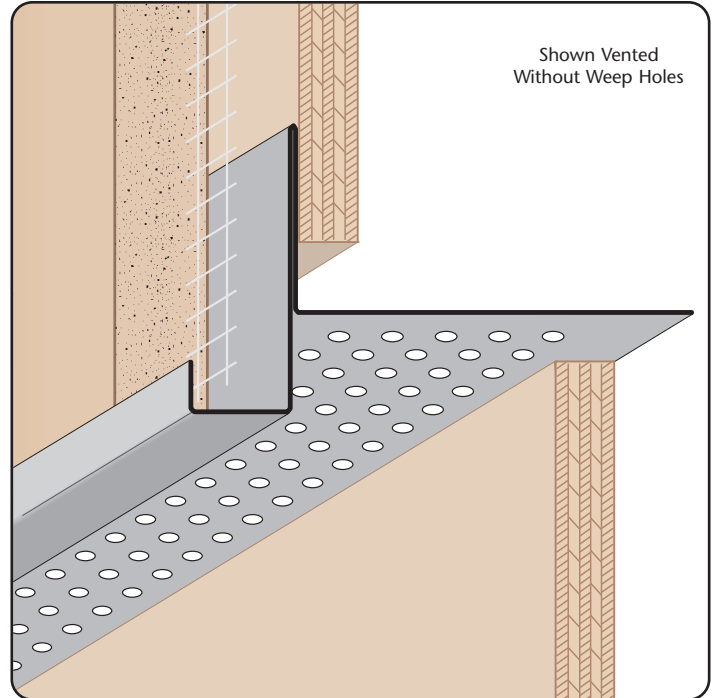

|              |                  |   |                    |
|--------------|------------------|---|--------------------|
| <b>QUOTE</b> | Company: _____   | QTY: _____  | PO Number: _____   |
|              | Name: _____      | Material/Gauge: _____   | Job/Project: _____ |
|              | Address: _____   | X Size: _____   | Notes: _____       |
|              | City: _____      | Y Size: _____   | _____              |
|              | State/ZIP: _____ | Length: _____   | _____              |
|              | Phone: _____     | Vent Holes: <input type="checkbox"/> None <input type="checkbox"/> 1/8" <input type="checkbox"/> 1/4" | _____              |
|              | eMail: _____     | Weep Holes: <input type="checkbox"/> None <input type="checkbox"/> 1/8"                               | _____              |

**877-786-2587 • StocktonProducts.com**

