



CUSTOM SIZES AVAILABLE!

Stockton Custom Fabrication

877-786-2587

custom@StocktonProducts.com



PRODUCTS™

ECX: End Cap With Tapeable Flange

- Custom Sizes Available, Contact Customer Service For Details
- Optional Key Holes in Tape Flange
- Available Anodized, PaintLoc (PTL) or Jet Kote (JTC) Finished
- Available in Aluminum (A)

Used as an end cap to finish off partition walls. Standard length is 10 foot. The ECX End Cap has optional holes in the taping flange for keying the drywall mud.

Most Common Sizes

X Sizes: 3 3/4", 3 7/8", 4 7/8", 5 1/4" or 7 1/4"

Y Sizes: 1 1/4"

Length: 120" or 144"

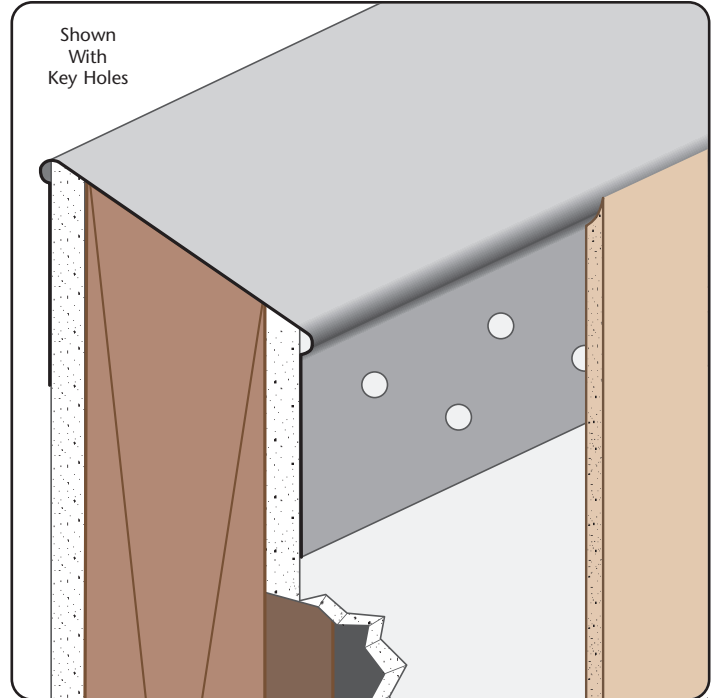

Materials And Finishes:

Details: stpro.us/MET

Aluminum (A)

ASTM Codes:

Details: stpro.us/ASTM

A1003, A653, A924, C645, C754, C955

Most Common Part Numbers:

ECX3750JTC ECX: X=3 3/4, A, 10', JTC

ECX3875JTC ECX: X=3 7/8, A, 10', JTC

ECX4875JTC ECX: X=4 7/8, A, 10', JTC

ECX725JTC ECX: X=7 1/4, A, 10', JTC

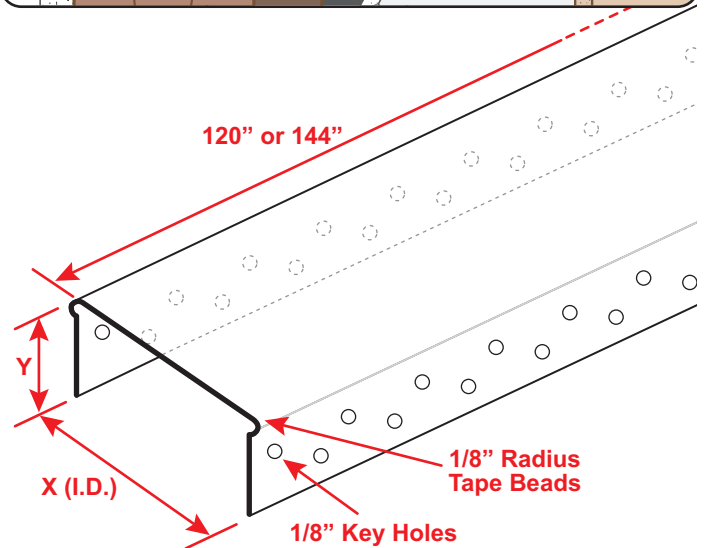

QUOTE	Company: _____	QTY: _____	PO Number: _____
	Name: _____	Material/Gauge: _____	Job/Project: _____
	Address: _____	X Size: _____	Notes: _____
	City: _____	Y Size: _____	_____
	State/ZIP: _____	Length: _____	_____
	Phone: _____	Key Holes: <input type="checkbox"/> None <input type="checkbox"/> 1/8"	_____
	eMail: _____		_____

877-786-2587 • StocktonProducts.com

