

DRML: Edge Trim

- Available Curved Upon Request
 - Available in Aluminum Alloy (6063 T-5)
- "L" style drywall molding with a taping flange that provides a drywall termination point by capping of the raw edge of the drywall board. Includes key holes for drywall mud adhesion.

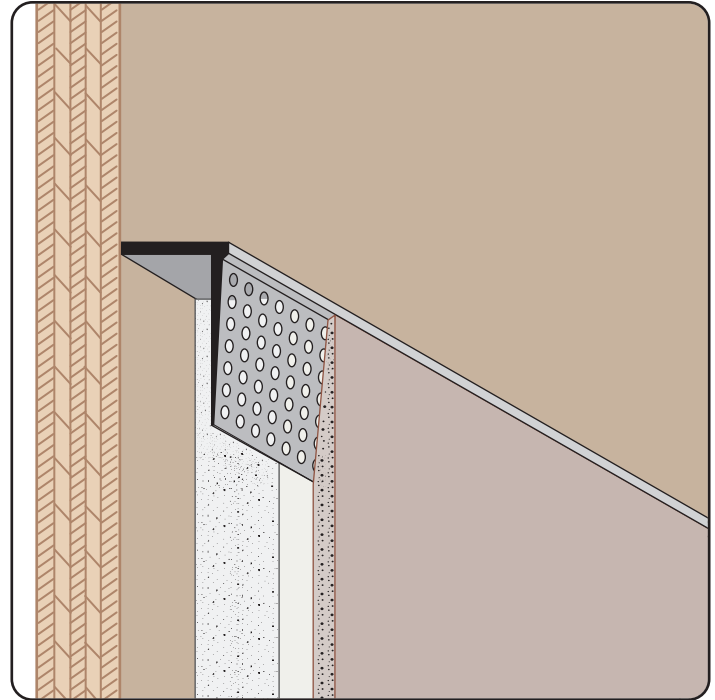

Most Common Sizes

X Sizes: 1/2", 5/8", 3/4", 1", 1 1/2", 2" or 3"
Y Sizes: 7/8"
Length: 10'

Materials And Finishes:

Details: stpro.us/EXT
 Aluminum Alloy (6063 T-5)

ASTM Codes:

Details: stpro.us/ASTM
 AA-M32-C10A21, AAMA 605.2, C841, C1047, C1063, B136-84, B244-97, D4214-98, ND1730-67-TYPE B

Most Common Part Numbers:

DRML100EC	DRML: X=1, Clear Anodize, A, 10'
DRML100ECH	DRML: X=1, Chem-Film, A, 10'
DRML50EC	DRML: X=1/2, Clear Anodize, A, 10'
DRML50ECH	DRML: X=1/2, Chem-Film, A, 10'
DRML625EC	DRML: X=5/8, Clear Anodize, A, 10'
DRML625ECH	DRML: X=5/8, Chem-Film, A, 10'
DRML75EC	DRML: X=3/4, Clear Anodize, A, 10'
DRML75ECH	DRML: X=3/4, Chem-Film, A, 10'

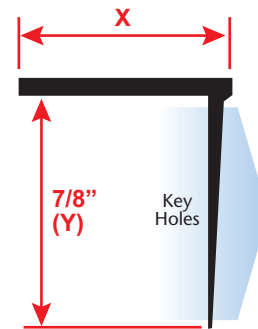

QUOTE	Company: _____	QTY: _____	PO Number: _____
	Name: _____	Material: Aluminum Alloy (6063 T-5)	Job/Project: _____
	Address: _____	X Size: _____	Notes: _____
	City: _____	Y Size: _____	_____
	State/ZIP: _____	Length: _____	_____
	Phone: _____		_____
	eMail: _____		_____

877-786-2587 • StocktonProducts.com

