

# DMCT: High Strength Corner Trim

- Available Curved Upon Request
  - Available in Aluminum Alloy (6063 T-5)
- A 90° outside corner with taping flanges for drywall. Provides a high strength corner for high impact areas. Includes key holes for drywall mud adhesion.

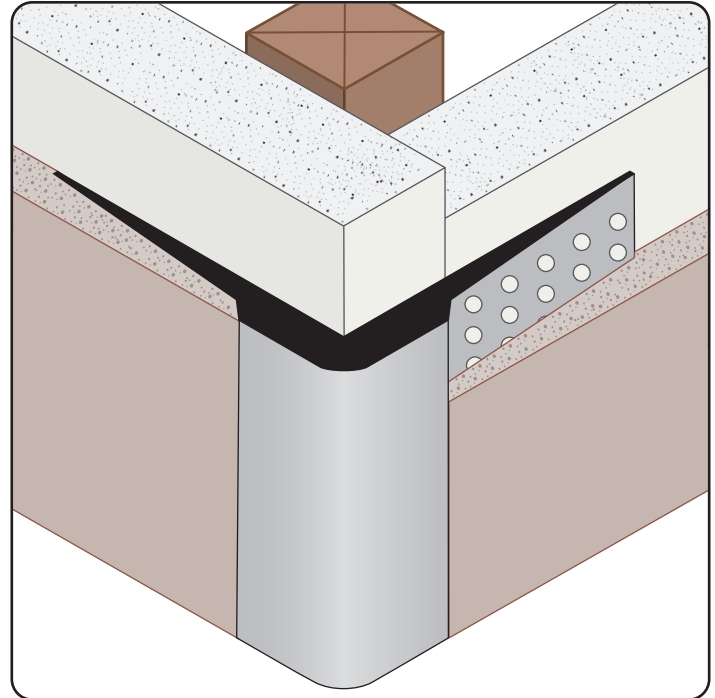

## Most Common Sizes

**Length:** 10'



### Materials And Finishes:

Details: [stpro.us/EXT](http://stpro.us/EXT)  
Aluminum Alloy (6063 T-5)

### ASTM Codes:

Details: [stpro.us/ASTM](http://stpro.us/ASTM)  
AA-M32-C10A21, AAMA 605.2, C841, C1047, C1063,  
B136-84, B244-97, D4214-98, ND1730-67-TYPE B

### Most Common Part Numbers:

**DMCT375EC** DMCT: X=3 3/4, Clear Anodize, A, 10

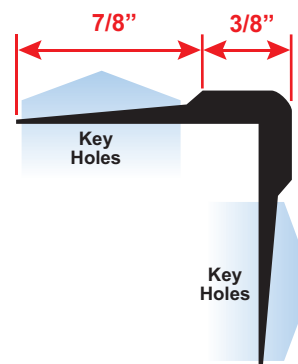

<b>QUOTE</b>	Company: _____	QTY: _____	PO Number: _____
	Name: _____	Material: Aluminum Alloy (6063 T-5)	Job/Project: _____
	Address: _____	Length: _____	Notes: _____
	City: _____		_____
	State/ZIP: _____		_____
	Phone: _____		_____
	eMail: _____		_____

**877-786-2587 • StocktonProducts.com**

