



CUSTOM SIZES AVAILABLE!

Stockton Custom Fabrication

877-786-2587

custom@StocktonProducts.com



PRODUCTS®

CICJ: #9 Control Joint

- Custom Sizes Available, Contact Customer Service For Details
- *Water Tested per ASTM E1105*
- SUPERIOR® Moisture Protection
- Available With 1/4" Weep Holes or No Holes
- Available Curved Upon Request
- Available in Aluminum (A), Copper (C), Galvanized Steel (GS), Bonderized (BN), Galvalume® (GVM), Stainless Steel (SS) or Zinc (Z)

CICJ is a drainage point control joint for CI (continuous insulation) stucco assemblies. The ground points can be customized to accommodate any combination of rigid insulation and stucco CI system. Available with or without weep holes.

US Patent 7,673,421

Most Common Sizes

X Sizes: 7/8", 1 1/8", 1 1/2" or 1 7/8"

Length: 120"

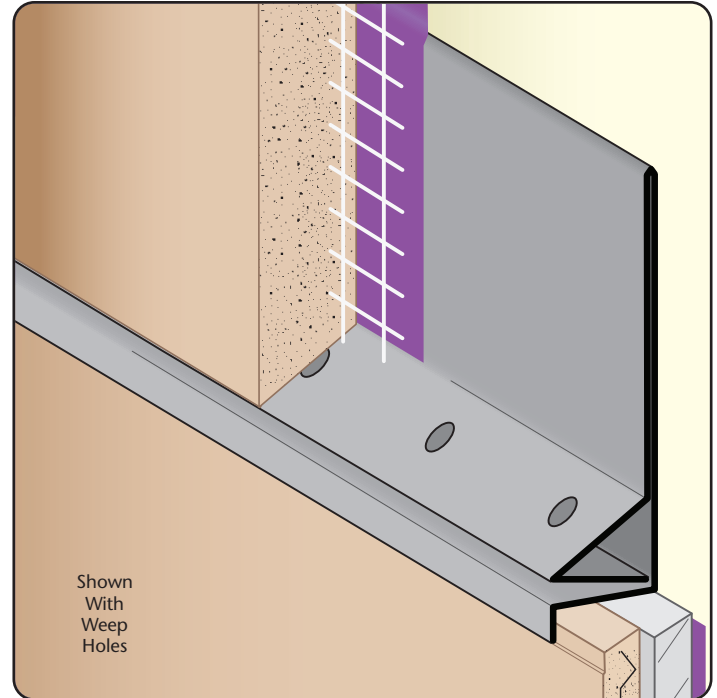

Materials And Finishes:

Details: stpro.us/MET

Aluminum (A), Copper (C), Galvanized Steel (GS), Bonderized (BN), Galvalume® (GVM), Stainless Steel (SS) or Zinc (Z)

ASTM Codes:

Details: stpro.us/ASTM

All Accessories are fabricated from prime galvanized steel G90 zinc coating by the hot dipped method, conforming to steel and coating specification ASTM A-653/A-653M or zinc alloy meeting ASTM B-69. Stainless Steel A480/A480M A580M (Stainless Steel) For installation and placement instructions refer to ASTM C1063, C841 and C926.

**SUPERIOR®
Moisture
Protection**

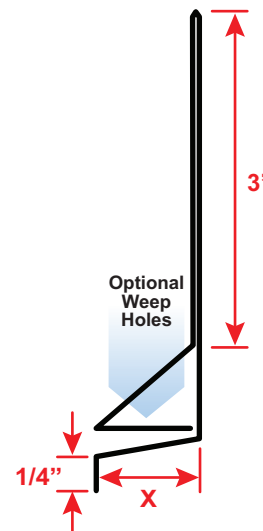

QUOTE	Company: _____	QTY: _____	PO Number: _____
	Name: _____	Material/Gauge: _____	Job/Project: _____
	Address: _____	X Size: _____	Notes: _____
	City: _____	Length: _____	_____
	State/ZIP: _____	Weep Holes: <input type="checkbox"/> None <input type="checkbox"/> 1/4"	_____
	Phone: _____		_____
	eMail: _____		_____

877-786-2587 • StocktonProducts.com

